

# TIDAL

## BACKPACK SPRAYERS



TIDAL - TORRENT 9 Gallon  
LITHIUM ION BACKPACK SPRAYER  
by SYSTEMS Environmental Products

### OPERATION GUIDE

[www.systemsenvironmental.com](http://www.systemsenvironmental.com)

## LET'S GET SPRAYING!

Congratulations on choosing one of the leading multi-purpose backpack sprayers available today. The TIDAL line of backpack sprayers can be used to apply any number of solutions and solvents in lawn care, pest control, disinfecting, soft wash and construction! Please read and follow this manual carefully to ensure that you get the most from your new backpack sprayer.

Because the TIDAL Backpack line is a product of SYSTEMS Environmental Products, you are working with a world-class manufacturer, with exceptional customer service and over 25 years in the sprayer industry.

If you need assistance with the assembly or operation of your backpack sprayer, please do not hesitate to contact us at:



[www.systemsenvironmental.com](http://www.systemsenvironmental.com)

---



[info@systemsenvironmental.com](mailto:info@systemsenvironmental.com)

---



1-800-367-4015

The TIDAL line of backpack sprayers are exceedingly efficient sprayers that are suitable for spraying many kinds of water-soluble chemicals such as fertilizers, pesticides, cleaning products, sealers, etc.

***Please note, never operate the sprayer with flammable liquids and strong acids.***

The TIDAL backpack line of sprayers are powered by an 18-volt lithium-ion battery making them many times more efficient than other manual sprayers. This sprayer is capable of 2 hours of continuous spraying and can spray more than 40 gallons of material per battery charge at 25 feet.



| TIDAL - SURGE 4 Gallon Sprayer Specifications |                |
|---|----------------|
| Model number                                  | TIDAL-TORRENT9 |
| Battery type                                  | lithium-ion    |
| Battery voltage                               | 18V            |
| Battery capacity                              | 5200mAH        |
| Battery charging time                         | 1.5 hours      |
| Battery charger                               | 5V/1A          |
| Battery life cycle                            | 1000 cycles    |
| Pump type                                     | diaphragm      |
| Working time                                  | 2.66 hours     |
| Dual-speed switch                             | 60 or 95 PSI   |
| Max. spray distance                           | > 30 feet      |
| Tank capacity                                 | 9 gallons      |
| GPM   | 0.66 GPM       |
| Pump life                                     | 200 hours      |

# WHAT'S IN THE BOX?

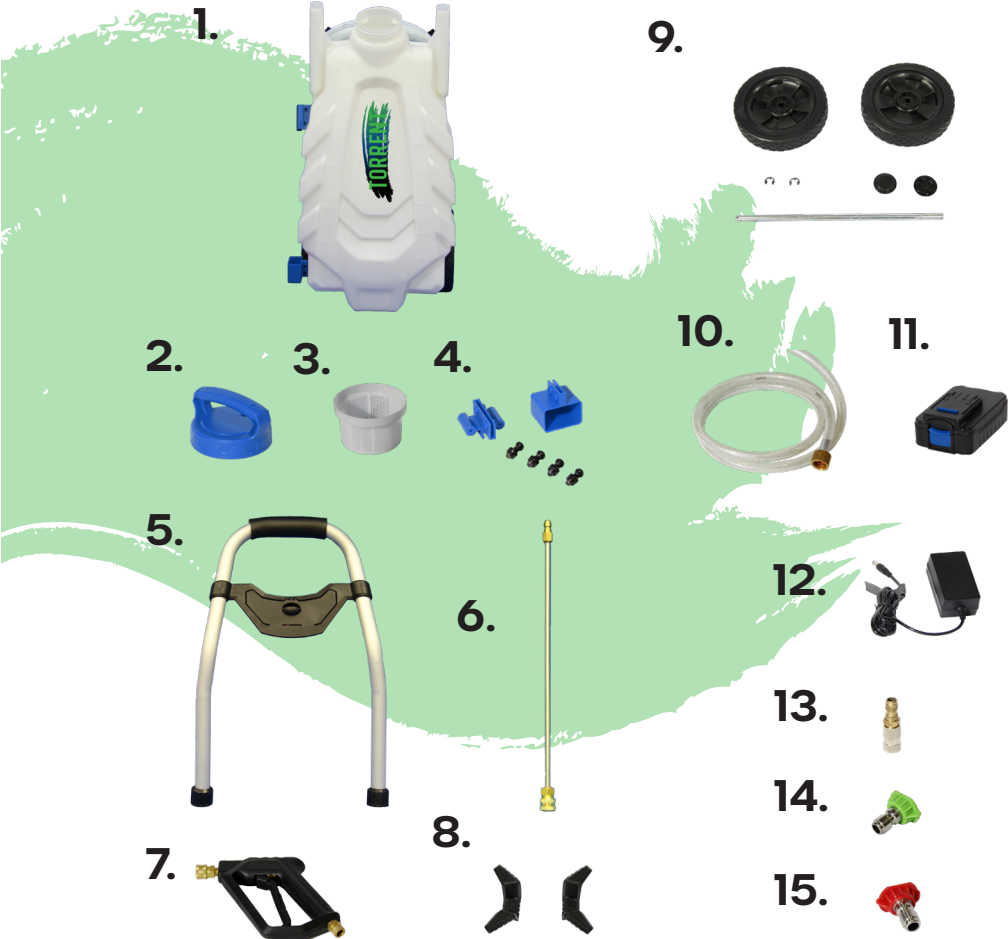

|                                |  |
|--------------------------------|--|
| 1. 9 gallon tank               | 9. Wheels, axle, cotter pins & wheel cap |
| 2. Tank cap                    | 10. Reinforced high pressure hose        |
| 3. Intake filter               | 11. 18-volt lithium-ion battery          |
| 4. Wand holster & bolts        | 12. Battery charger                      |
| 5. Cart handle & storage bin   | 13. Adjustable cone nozzle               |
| 6. Spray wand lance            | 14. 25 degree fan nozzle                 |
| 7. Spray wand trigger          | 15. Pin stream nozzle                    |
| 8. Hose holders (cart mounted) | 16. Instruction manual                   |

## GETTING STARTED

1. Charge the battery before using the first time.



2. Fill the sprayer through the intake filter and secure the cap.

*NOTE - Always mix your solution in a separate container before and pour into the sprayer.*



3. Connect your spray wand to the high pressure hose.



4. Choose the nozzle best suited to your application and attach the spray wand lance.



5. Attach spray wand lance to high pressure spray gun.

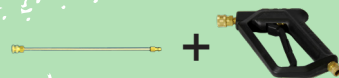

6. Turn on the pump by flipping the toggle switch.

- "I" setting runs the pump at 100 PSI.
- "II" setting runs the pump at 20 PSI.

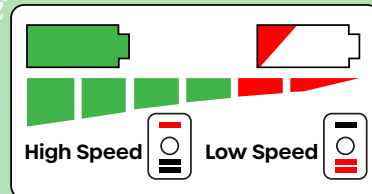

5. Squeeze the spray wand trigger and begin application.

## AFTER YOU SPRAY

1. Rinse the tank with water to remove any traces of the solution that was applied.
2. Run water through the sprayer, hose and spray wand tool for 1-3 minutes to flush out any residual solution from the plumbing. Always dispose of rinse solution in accordance with local regulations.
3. With the sprayer turned off, drain the hose and spray wand of any excess water.
4. Air dry the tank (remove the filter and tank cap).
5. Clean the nozzle.
6. Store the sprayer in a clean location away from extreme heat or frost. For extended periods of time, recharge and discharge the battery every 2 weeks to maximize battery life.

## REMEMBER!



Never operate the sprayer without liquid as this may damage the pump.

---



After long periods of inactivity, the battery may require additional charging due to low voltage.

---



Always follow the chemical label.

---



Always wear personal protective equipment when needed.

---



Never spray flammable liquids.

---



Always keep the sprayer out of reach of children and away from animals.

---



Always dispose of dead batteries at the proper recycling facilities. Check with your local municipality for more information.

---



Always store the sprayer inside at room temperature to avoid unnecessary damage.

---



Use only TIDAL replacement parts from SYSTEMS Environmental Products.

---



## WARRANTY CARD AND PURCHASE INFORMATION

Scan and email your warranty card to  
**info@systemsenvironmental.com**  
for your chance to win a free battery.

|                   |  |
|-------------------|--|
| DATE OF PURCHASE: |  |
| PURCHASED FROM:   |  |
| NAME:             |  |
| PHONE NUMBER:     |  |
| EMAIL:            |  |

**SYSTEMS**  
ENVIRONMENTAL PRODUCTS INC.  
PEST & TURF WEED



---

info@systemsenvironmental.com

---

1-800-367-4015

www.systemsenvironmental.com