

SLF TRAP

REUSABLE FULL SEASON RESERVOIR DESIGN

For: Spotted Lanternfly, (*Lycorma delicatula*)

TRAP INCLUDES:

- A. Screen trap body and reusable reservoir
- B. White wristlet
- C. Orange twine
- D. Velcro

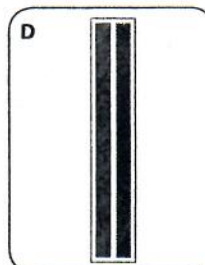
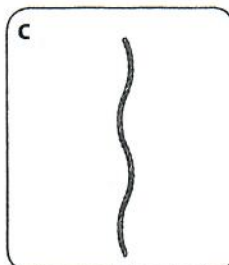
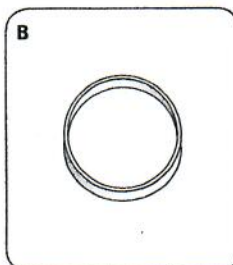
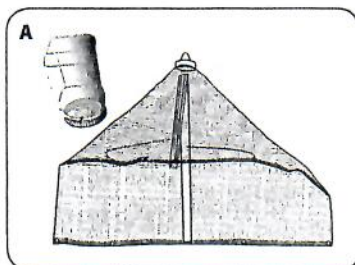

TRAP USE INSTRUCTIONS:

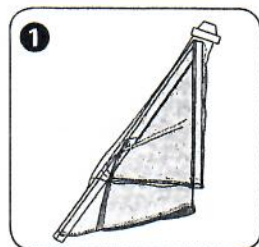

1. Remove screen trap body from box and unfold to resemble picture A.

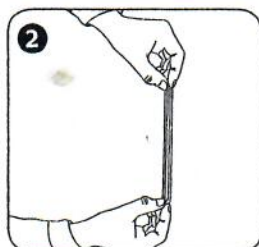

2. Fold orange twine in half.

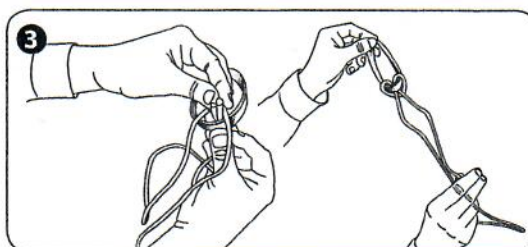

3. Place middle point of orange twine just behind the front of the white wristlet. Grab the ends of orange twine and loop through edge of wristlet and then through loop in orange twine.

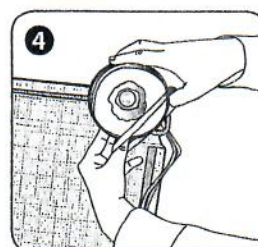

4. Stretch wristlet with twine and place over the mouth of the reusable reservoir.

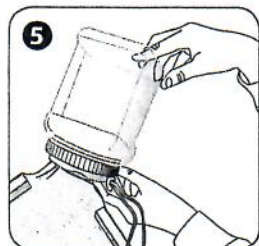

5. Twist reusable reservoir onto lid that is attached to the top of trap.

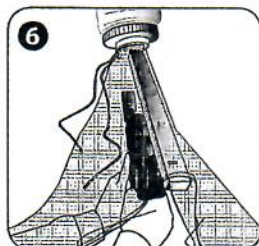

6. Attach trap to tree (about chest level) by drilling drywall screw through the middle point of 18" cedar strip.

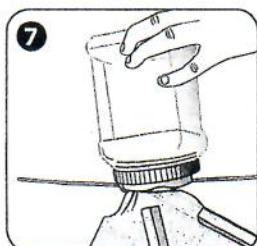

7. Bring both ends of orange twine around tree and tie in bow behind tree.

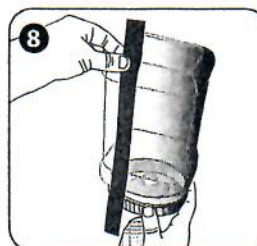

8. Remove sticky adhesive from back of Velcro and attach to the side of reusable reservoir that is closest to the tree.

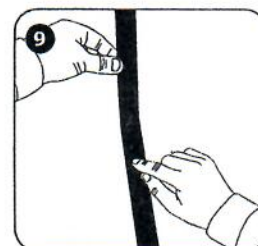

9. Attach other piece of Velcro directly to tree. Staple in place if needed.

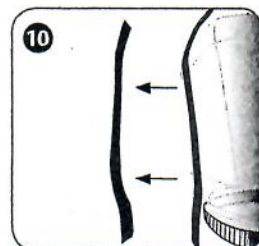

10. Press both Velcro pieces together. Make sure the reusable reservoir remains upright.

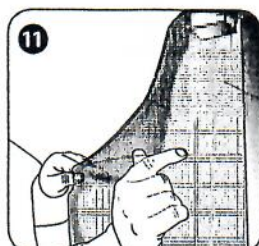

11. Bend the two wires back to help form the shape of the trap.

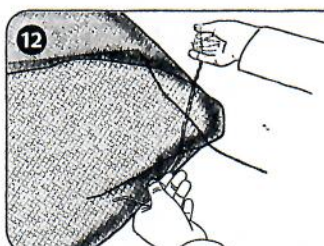

12. Using twine, fishing line, small thin rope, etc. Weave through eyelets at the bottom of trap. Tie twine behind tree.

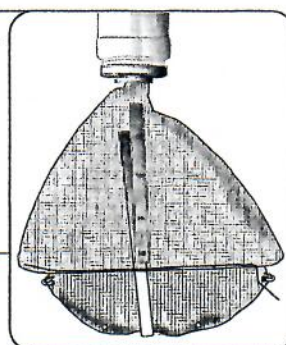

NOTE: Check and empty reusable reservoir at least twice a week.