

COMANDO A DISTANZA CD10
REMOTE CONTROL CD10
COMMANDE À DISTANCE CD10
FERNBEDIENUNGSARMATUR CD10
MANDO DE PRESIÓN A DISTANCIA CD10

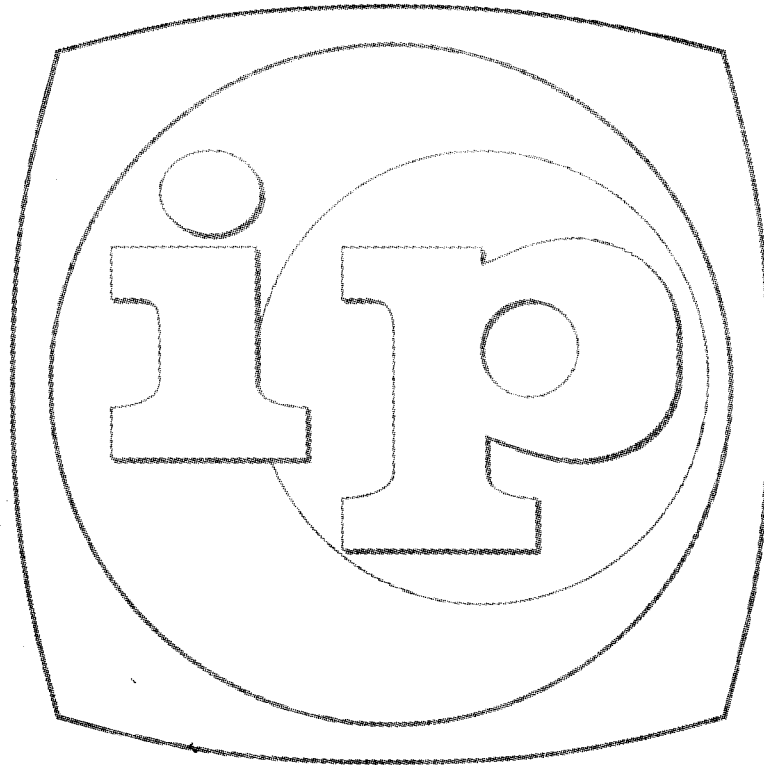

imovilli pompe

LIBRETTO D. ISTRUZIONI
INSTRUCTION MANUAL
MANUEL D'EMPLOI ET RENSEIGNEMENTS
BETRIEBSANLEITUNG
MANUAL DE INSTRUCCIONES Y MANEJO

REMOTE CONTROL CD10

IMPORTANT:

Imovilli Pompe control units have been designed mainly for use with agricultural sprayers. The construction materials have been studied to withstand the most common products used for plant and crop protection spraying.

The use of aggressive, thick or powdered liquids may affect its reliability and correct functioning; the abrasive products reduce the life of the wearing parts.

INSTALLATION: Before installing the control unit check that the delivery of the pump to be used in the system is adequate to the max. flow permitted for the control itself.  Install the control in place and fix firmly the appropriate bracket.

HOSES: Use hoses having the internal diameter of the same size of the hose tails supplied by Imovilli Pompe. The delivery hoses must withstand a pressure adequate to the pump used. It is advised to use a by-pass/return hose of min. 10 bar pressure.

All hoses must have clearly marked the max. working pressure allowed. Fix the hoses firmly on the hose tails by using hose clamps. The by-pass/discharge hose must be anchored inside the tank to prevent it from coming out accidentally.

It is also advisable to position the by-pass/discharge hose on the tank side opposite to the pump suction side to prevent possible turbulences and suction of air bubbles.

STARTING AND USE. Do not start the system unless all hoses are properly connected and fixed. Unscrew the pressure regulating knob (A) in the direction - bar (- ← +) marked on the knob itself.

 Bring the main ON-OFF lever (B) back into the OFF position. By doing so the entire flow is discharged without passing through the regulating valve and a better priming of the pump is achieved.

Start the pump. When the liquid flows regularly bring the lever (B) forward in position ON. Screw the pressure regulating knob in the direction + bar (- → +) until you reach the desired pressure.

ATTENTION! NEVER exceed the max. pressure allowed for the pump, marked on the pump label itself, nor the max. pressure for which the system has been designed.

 Anytime the main lever is in the OFF position the entire flow is being discharged without passing to the outlet valves.



AFTER USE

Follow carefully the instructions supplied in the pump instruction booklet. For a long and trouble free life wash the control unit thoroughly with clean water when finished spraying.

FAULTS AND REMEDIES:

The pressure desired cannot be achieved: inadequate flow; check pump flow. Regulating valve/seat worn. Change the worn out parts.

Leakage of water from valve body: damaged regulating valve diaphragm. Change.

Comandi a distanza Remote controls Commandes à distance Fernbedienungs-Armaturen Mandos a distancia	 PORTATA MAX DEBIT MAX DELIVERY MAX CAUDAL MAX FÖRDERLEISTUNG MAX		 PRESSIONE MAX PRESSION MAX PRESSURE MAX PRESION MAX DRUCK MAX	
	ℓ/1'	US.GPM	BAR	PSI
CD 10	110	31,7	50	725

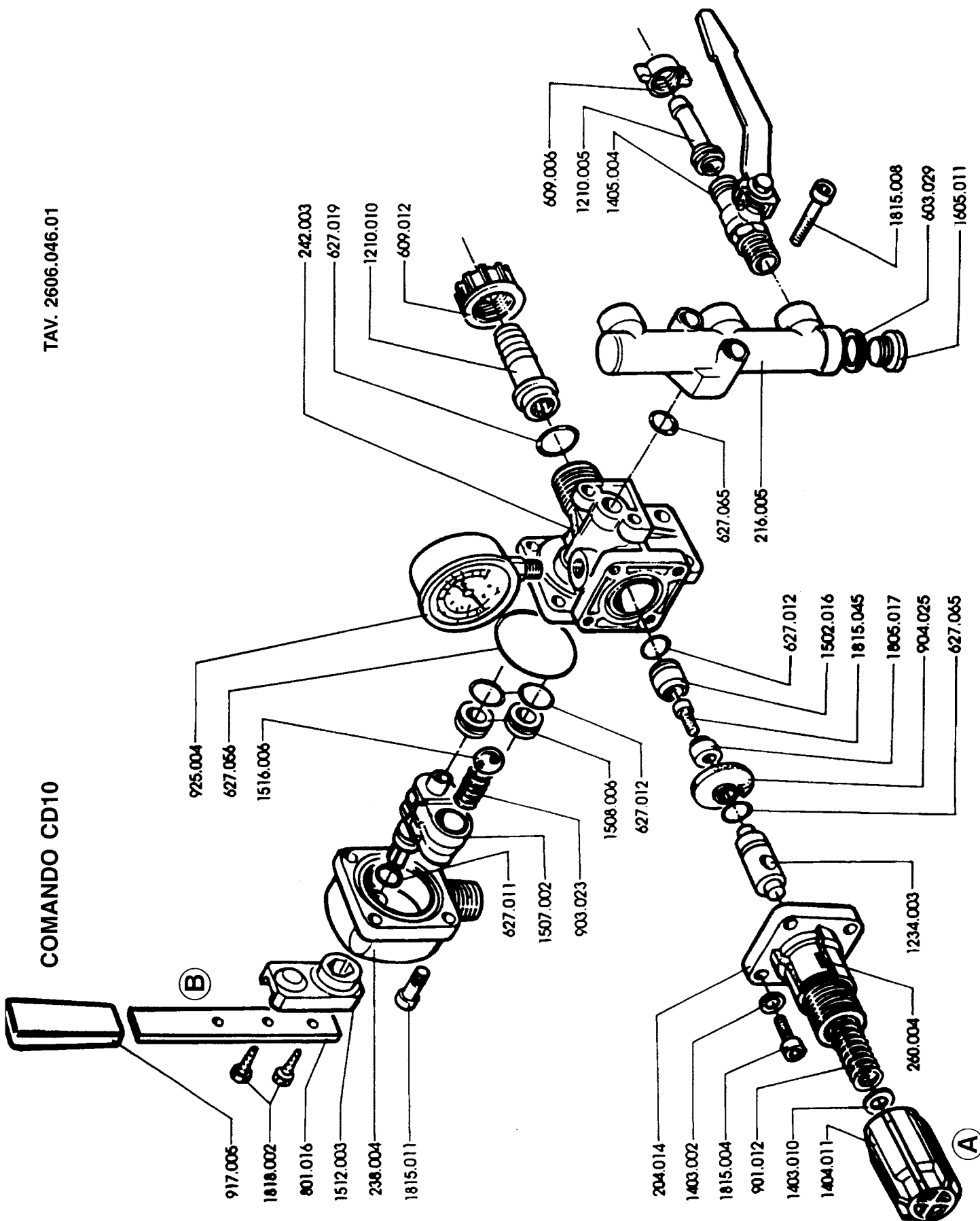

CODICE	DENOMINAZIONE	PEZZI
204.014	Corpo valvola reg.	1
216.005	Collettore rubinetti	1
238.004	Coperchio selettore	1
242.003	Corpo centralina	1
260.004	Cappuccio V.R.	1
603.029	Guarn. ø 22 x 16,5 x 2	1
609.006	Girello ø 1/2" OT	3
609.012	Girello ø 1" RS	1
627.011	Guarn. OR 2050	1
627.012	Guarn. OR 2056	3
627.019	Guarn. OR 3100	1
627.056	Guarn. OR 3200	1
627.065	Guarn. OR 3043	2
801.016	Leva	1
901.012	Molla valvola reg.	1
903.023	Molla x sfera ON-OFF	1
904.025	Membrana valvola reg. desmopan	1
917.005	Manopola 20 x 5	1
925.004	Manometro glic. SR 50	1
1210.005	Portagomma diritto ø 10 OT	3
1210.010	Portagomma diritto ø 25 RS	1
1234.003	Pistoncino V.R.	1
1403.002	Rondella ø 6 - UNI 6592	4
1403.010	Rondella bis. ø 8 x 17 - UNI 6592	1
1404.011	Registro pressione V.R.	1
1405.004	Rubinetto ø 1/2" - 3/8" DX nic.	3
1502.016	Sede valvola reg.	1
1507.002	Selettore ON-OFF	1
1508.006	Sede x sfera ON-OFF	2
1512.003	Supporto leva comando	1
1516.006	Sfera inox ø 18	1
1605.011	Tappo TE 3/8" all.	1
1805.017	Valvola reg.	1
1815.004	Vite TCEI - M 6 x 20 - 8.8 UNI 5931	4
1815.008	Vite TCEI - M 6 x 35 - 8.8 UNI 5931	2
1815.011	Vite TCEI - M 8 x 20 - 8.8 UNI 5931	4
1815.045	Vite TCEI - M 4 x 12 inox - UNI 5931	1
1818.002	Vite TE - AB 5,5 x 16 - UNI 6949	2