

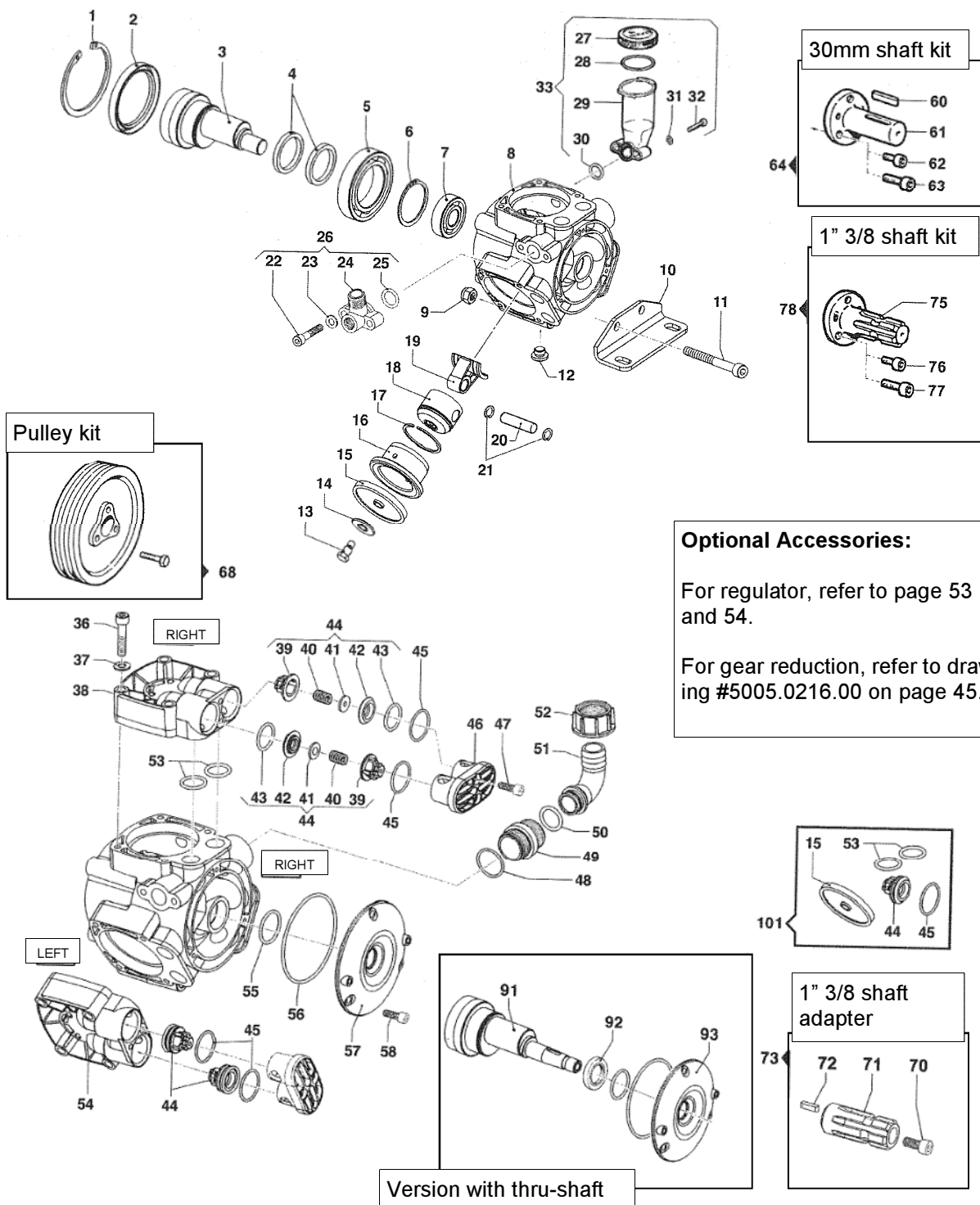

APS31 / APS41

APS31 / APS41



PRICES SUBJECT TO CHANGE WITHOUT NOTICE.

#	PART #	DESCRIPTION	NOTE	QTY
1	3020.0002.00	RETAINING CLIP	90	1
2	0019.0085.00	OIL SEAL	70x90x10	1
3	0001.0444.00	APS41 NON-THROUGHSHAFT	6 HOLES	1
	0001.0447.00	APS31 NON-THROUGHSHAFT	6 HOLES	1
4	0010.0026.00	CONNECTING ROD RING	52x42x6	2
5	0438.0001.00	BALL BEARING	55x90x18	1
6	3019.0001.00	OUTER SEAGER	55	1
7	0438.0066.00	BALL BEARING	20x52x15	1
8	0403.0147.00	PUMP CRANKCASE		1
9	0604.0073.00	NUT	M10x10	2
10	2400.0089.00	PUMP MOUNTING BRACKET		2
11	3609.0179.00	SCREW	M10x100	2
12	3200.0080.00	OIL PLUG	GC 1/4	1
13	3605.0027.00	DIAPHRAGM HOLDER SCREW	M8	3
14	0602.0033.00	DISC		3
15	1800.0020.00	DIAPHRAGM	BUNA	3
	1800.0102.00	DIAPHRAGM	DESMOPAN	3
	1800.0028.00	DIAPHRAGM	VITON	3
16	0400.0080.00	APS41 PISTON SLEEVE	48	3
	0400.0081.00	APS31 PISTON SLEEVE	48	3
17	0020.0010.00	COMPRESSION RING	48x2x2	3
18	2409.0097.00	PISTON	48	3
19	0205.0069.00	CONNECTING ROD ASSEMBLY		1
20	3011.0024.00	CONNECTING ROD PIN	14x40,5	3
21	3020.0029.00	RETAINING CLIP	14	6
22	3609.0165.00	SCREW	M8x35	2
23	2811.0004.00	WASHER	8,4x14x1,6	2
24	2803.0467.00	STANDARD OUTLET	G 1/2	1
	2803.0468.00	OPTIONAL OUTLET	G 3/4	1
25	1210.0447.00	O-RING	3,0x19	1
26	5004.0151.00	STANDARD OUTLET KIT	G 1/2	1
	2803.0474.00	OPTIONAL OUTLET KIT	G 3/4	1
27	0402.0141.00	VOLUM.COMPENSATOR COVER		1
28	1210.0122.00	O-RING	2,62x44,12	1
29	0421.0015.00	VOLUMETRIC COMPENSATOR		1
30	1210.0233.00	O-RING	1x78x18,77	1
31	2811.0004.00	WASHER	8,4x14x1,6	2
32	3609.0002.00	SCREW	M8x25	2
33	1208.0013.00	VOLUMETRIC COMPENS. KIT		1
36	3609.0014.00	SCREW	M8x55	12
37	2811.0004.00	WASHER	8,4x14x1,6	12
38	3218.0308.00	RIGH PUMP MANIFOLD		2
39	1205.0035.00	SUCT./DELIV. VALVE CAGE		6
40	1802.0177.00	SUCT./DELIV. VALVE SPRING		6
41	3604.0007.00	SUCTION DELIVERY VALVE		6
42	3009.0134.00	SUCT./DELIVERY VALVE SEAT		6

#	PART #	DESCRIPTION	NOTE	QTY
43	1210.0451.00	O-RING	2X24	6
44	1220.0052.00	SUCT./DELIV. VALVE ASSY KIT		6
45	1210.0015.00	O-RING	1,78x28,3	6
46	3202.0259.00	SUCT./DELIVERY VALVE PLUG		3
47	3609.0032.00	SCREW	M6x20	6
48	1210.0145.00	O-RING	2,62x28,25	1
49	2000.0100.00	NIPPLE	M-M G1"	1
50	1210.0048.00	O-RING	2,62x20,24	1
51	2801.0075.00	SUCTION ELBOW TAIL	25	1
52	1200.0049.00	WING NUT	G1"	1
53	1210.0048.00	O-RING	2,62x20,24	6
54	3218.0309.00	LEFT PUMP MANIFOLD		1
55	1210.0101.00	O-RING	2,62x29,82	1
56	1210.0225.00	O-RING	2,62x88,57	1
57	1009.0181.00	FLANGE		1
58	3609.0032.00	SCREW	M6x20	3

#	PART #	DESCRIPTION	NOTE	QTY
64	5003.0014.00	1" SHAFT KIT	30	1
	5003.0041.00	30MM SHAFT KIT	1"	1
68	5001.0052.00	10" 2A GROOVE PULLEY KIT		
73	5003.0046.00	1"3/8 PTO SHAFT ADAPTER		
78	5003.0007.00	1"3/8 PTO SHAFT KIT		

#	PART #	DESCRIPTION	NOTE	QTY
91	0001.0445.00	CONIC THROUGHSHAFT	HOLES-20	1
92	0019.0110.00	OIL SEAL	20X30X7	1
93	1009.0182.00	FLANGE		1

#	PART #	DESCRIPTION	NOTE	QTY
101	5026.0245.00	REBUILD KIT (BUNA)		1
	5026.0327.00	REBUILD KIT (DESMO)		1